

ACCESS DETAIL

PROPOSED DEVELOPMENT OF LOT 5392R

LOT 5392R SHOWN IN INS# 2023-004154

CURRENT APN: 103-35-188A

CURRENT ZONING: C2 PAD
PROPOSED ZONING: RS

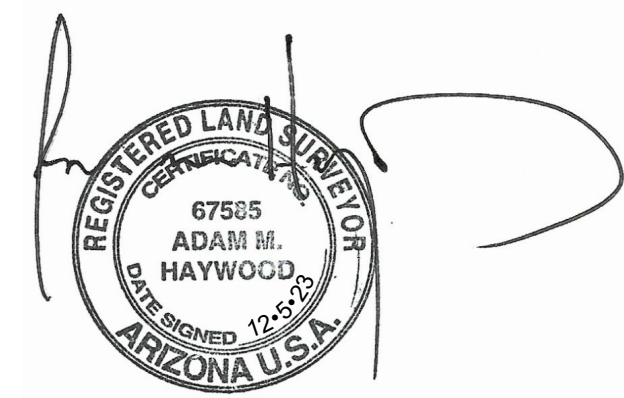
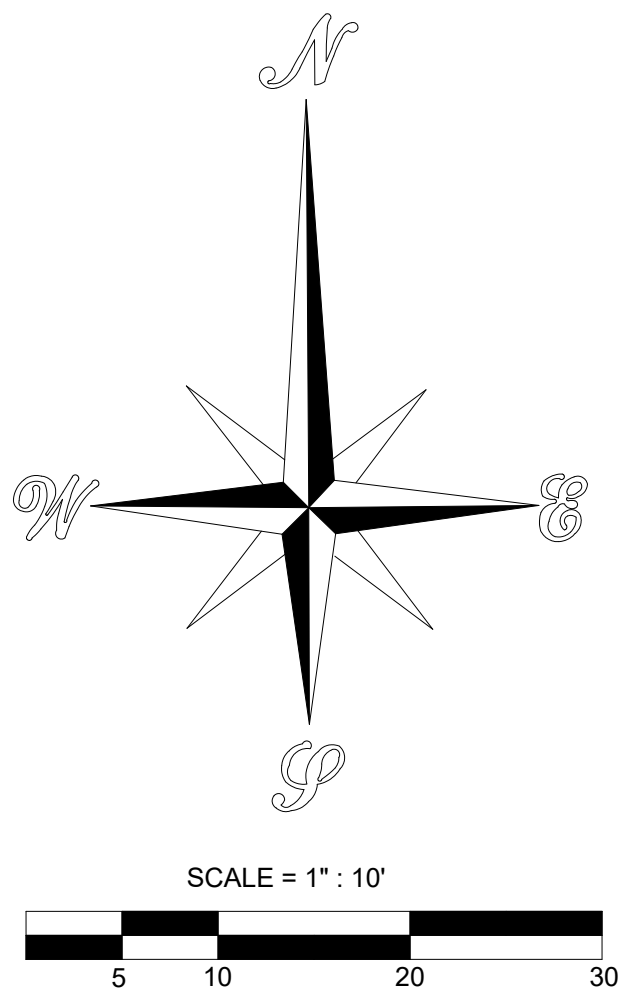

APN: 103-35-188A
7565 E. Addis Ave
Prescott Valley, AZ, 86314

APN: 103-35-755H
CENTRAL ARIZONA FIRE
AND MEDICAL AUTHORITY

15 GAL QUAKING ASPEN, AUTUM BLAZE MAPLE
OR SIMILAR, SEE TOWN OF PRESCOTT VALLEY
SUGGESTED LIST TYP. OF 4

SUBJECT PARCEL

DRIVEWAY

LOV PORCH

NEW DRIVEWAY/ROADWAY
TO BE IMPROVED TO TOWN OF
PRESCOTT VALLEY STANDARDS

IMPROVED
SURFACE
20'

APN: 103-35-187
HINMAN PROPERTIES LLC

APN: 103-35-186
HINMAN PROPERTIES LLC

APN: 103-35-185
HINMAN PROPERTIES LLC

EXISTING
PARKING LOT
ACCESS TO APN 103-35-182A

APN 103-35-182A
EXISTING
COMMERCIAL BUILDING
HINMAN PROPERTIES LLC

20'
EXISTING
PAVED ROADWAY
(CHIPSEAL)

EXISTING
PAVED ROADWAY
(CHIPSEAL)
ENDS HERE

BORDERLANDS LLC
REGISTERED LAND SURVEYORS
212 S. MARINA ST.
PRESCOTT, AZ 86303
(928)925-6135

JOB NO. WTH	DRAWN: AMH
CLIENT: KNOCK	CHECK: AMH
CREW: AMH	CREW: N/A
SCALE = 1" : 10'	SHEET SIZE: 36X48" - ARCH D